

Room Capacities

	Theatre	Theatre (Back Projection)	Classroom	Boardroom	U-Shape	Cabaret (Full rounds)	Cabaret (Half rounds)	Banquet	Dinner Dance	Length (m)	Width	Height	Controls in Room	Tungsten	Dimmers	Blackout	Natural Light	3 Phase	Air Conditioning	Free WiFi
Dragon Suite	300	-	120	50	70	144	-	290	250	15	14	6.3	•	-	•	•	-	-	•	•
Prince of Wales Suite	120	-	60	-	-	80	-	120	60	27.5	5.1	3.6	•	-	-	-	•	-	•	•
Prince of Wales Suite 1	70	-	30	38	30	-	-	60	-	13.5	5.1	3.6	•	-	•	-	•	-	•	•
Prince of Wales Suite 2	25	-	12	12	12	-	-	-	-	7	5.1	3.6	•	-	-	-	•	-	•	•
Prince of Wales Suite 3	30	-	15	15	12	-	-	-	-	7	5.1	3.6	•	-	-	-	•	-	•	•
Foxhunter	60	-	24	30	24	32	-	60	-	9.2	5.5	3.6	•	-	-	-	•	-	-	•
Glamorgan	60	-	24	24	16	32	-	-	-	6.4	5.4	3.6	•	-	-	-	•	-	-	•
St. David's	30	-	16	18	12	16	-	-	-	5.4	5.1	3.6	•	-	-	-	•	-	-	•
Rhymney	15	-	10	12	10	-	-	-	-	5.4	5.4	3.6	•	-	-	-	•	-	-	•
Clocktower	15	-	10	12	10	-	-	-	-	9.8	8.2	3.6	•	-	-	-	•	-	-	•

• Available - Not Available

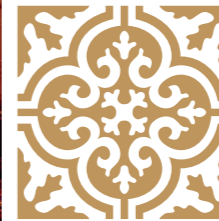

Floorplans and capacity charts



THE
ANGEL
HOTEL
CARDIFF

Floorplans

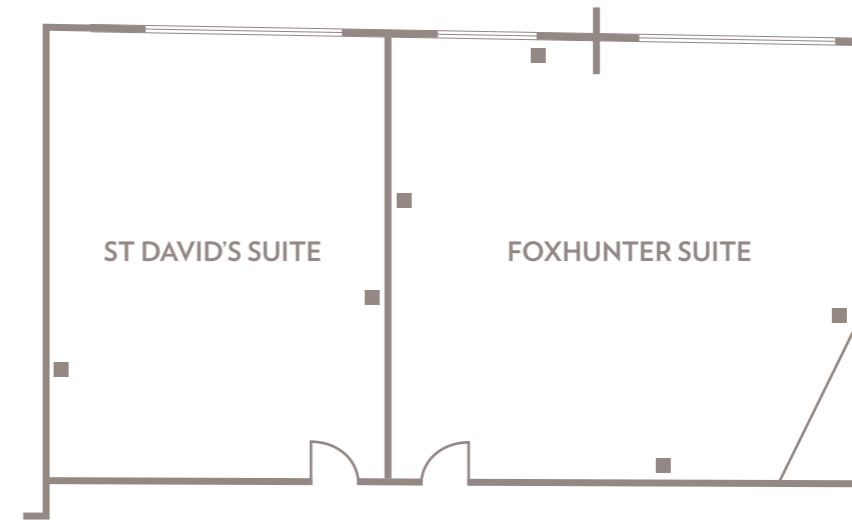
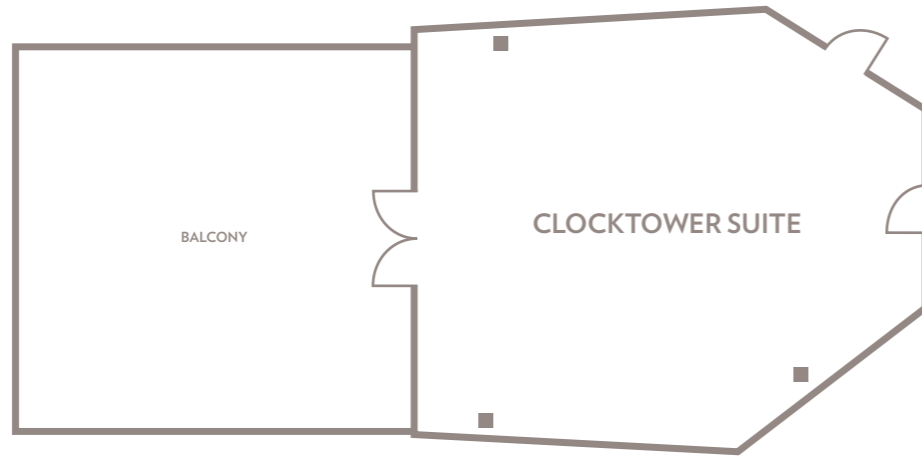
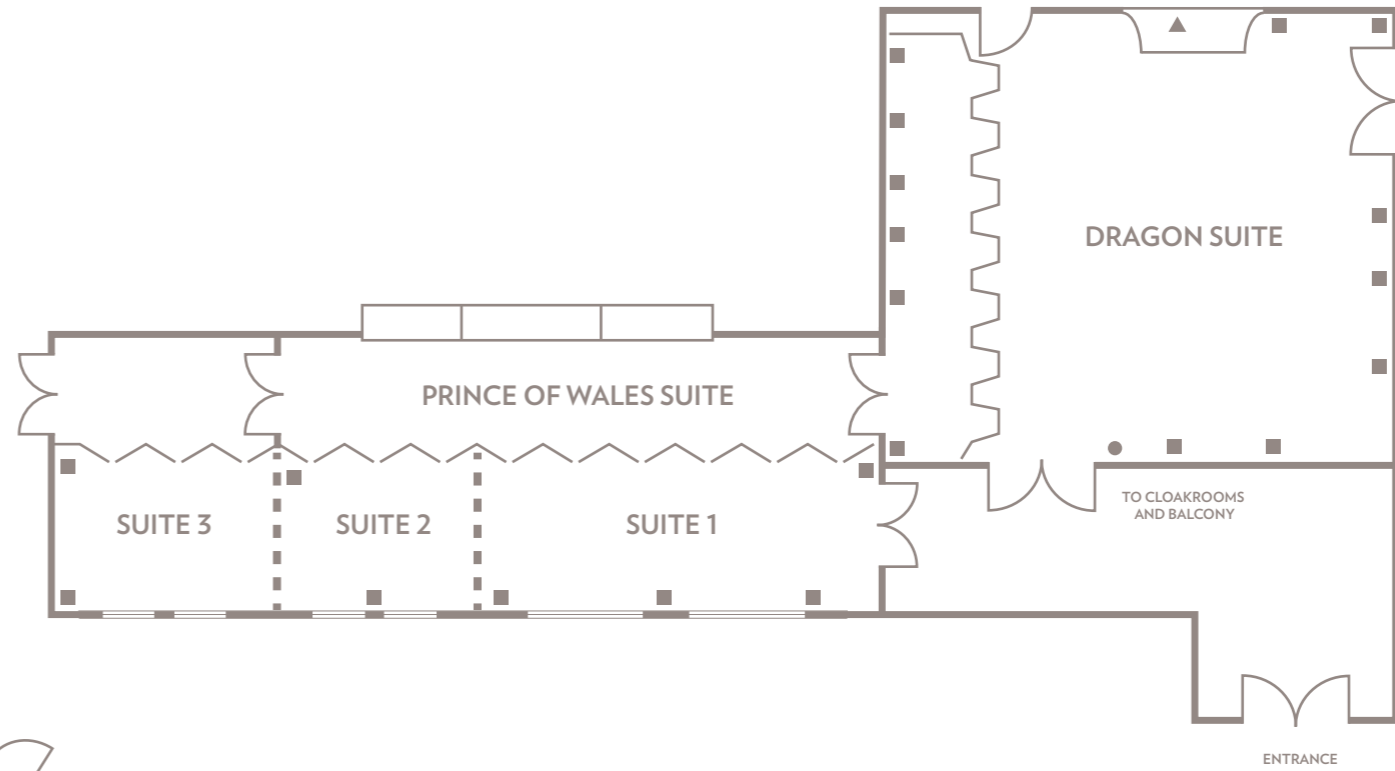

▲ AERIAL SOCKET ■ 13 AMP SOCKET DOUBLE ● TELEPHONE POINT - - - - MOVABLE ACOUSTIC PARTITION

